

# **ACCESSORIES**

# ACCESSORIES

As accessories customers may order brackets and stand profiles according to article numbers. Roses, plugs and packing can be ordered using specific names indicated on Fig. 1 Accessories.

In addition to the above it is necessary to specify, whether the rose should be provided with left-hand or right-hand thread. Every set of radiator has 2 left-hand and 2 right-hand threads. In the front view of the radiator on the right-hand side there is the left-hand thread and on the left-hand side there is the right-hand thread.

Internal thread in the rose can be 3/8", 1/2", 3/4" or 1". Plug is a full rose.

**KALOR, KALOR 3, BOHEMIA  
BOHEMIA R, ATENA, WINDSOR**

**TERMO, STYL**

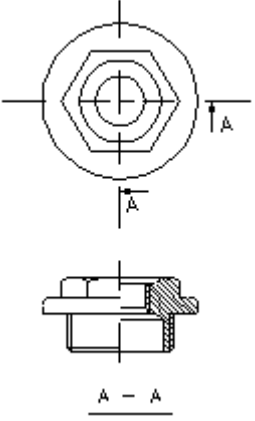
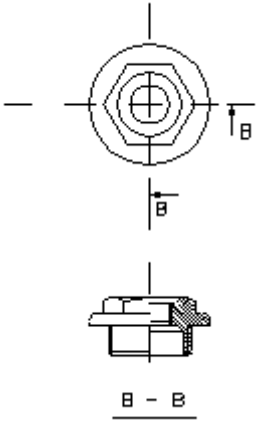
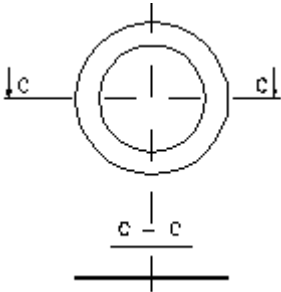
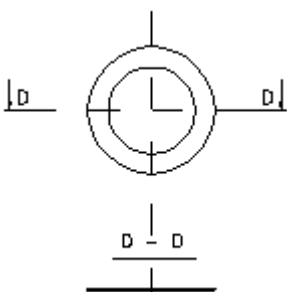
	
<p><b>ROSE 5/4" WITH 3/4" INTERNAL THREAD</b> Supply number 2503 left Supply number 2502 right</p> <p><b>ROSE 5/4" WITH 1/4" INTERNAL THREAD</b> Supply number 2497 left Supply number 2498 right</p> <p><b>ROSE 5/4" WITH 1/2" INTERNAL THREAD</b> Supply number 2500 left Supply number 2499 right</p> <p><b>ROSE 5/4" WITH 3/8" INTERNAL THREAD</b> Supply number 2953 left Supply number 2952 right</p> <p><b>ROSE 5/4" WITH 1/8" INTERNAL THREAD</b> Supply number 3417 left Supply number 3418 right</p> <p><b>ROSE 5/4" WITH 1" INTERNAL THREAD</b> Supply number 8317 left Supply number 8318 right</p>	<p><b>ROSE 1" WITH 3/4" INTERNAL THREAD</b> Supply number 2884 left Supply number 2885 right</p> <p><b>ROSE 1" WITH 1/4" INTERNAL THREAD</b> Supply number 2881 left Supply number 2880 right</p> <p><b>ROSE 1" WITH 1/2" INTERNAL THREAD</b> Supply number 2883 left Supply number 2882 right</p> <p><b>ROSE 1" WITH 3/8" INTERNAL THREAD</b> Supply number 2879 left Supply number 2878 right</p> <p><b>ROSE 1" WITH 1/8" INTERNAL THREAD</b> Supply number 3405 left Supply number 3404 right</p>
	
<p><b>CLINGERITE PACKING 60 x 42 x 1 mm</b> Supply number 9686</p>	<p><b>CLINGERITE PACKING 50 x 33 x 1 mm</b> Supply number 9689</p>

		
<b>RADIATOR NIPPLE G 5/4"</b> Supply number 2493	<b>RADIATOR NIPPLE G 1"</b> Supply number 2494	
		
<b>ROSE 5/4" PLUG</b> Supply number 2495 left Supply number 2496 right	<b>ROSE 1" PLUG</b> Supply number 2876 right Supply number 2877 left	
		
<b>STRIPPING SPANNER 5/4"</b> (width 29 mm) <b>KALOR, KALOR 3, BOHEMIA</b> Supply number 3251	<b>STRIPPING SPANNER 1"</b> (width 23 mm) <b>TERMO, STYL</b> Supply number 3252	<b>STRIPPING SPANNER 1"</b> (width 26 mm) <b>TERMO, STYL</b> Supply number 14 845

Fig. 1 Accessories

## We recommend to fix the heating bodies using one of the following methods

Installation of Bohemia, Bohemia R, Atena a Windsor heating bodies should be performed by their positioning on the feet of the body.

For the radiators Kalor, Kalor 3, Termo, Styl we do recommend hangers of the firm WEMEFA.  
(Sales agency WEMEFA, Mr. Lát, Gorkého 1577, 53002 Pardubice,  
tel: +420466304133, cell: +420602483036, info@obzaho.com, www.obzaho.com)

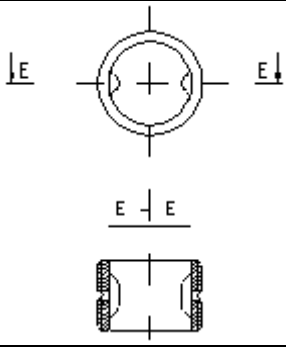
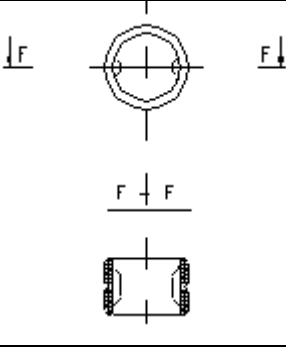
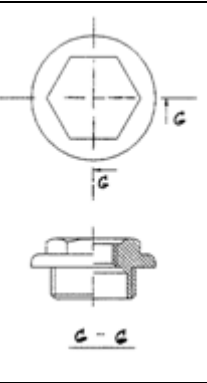
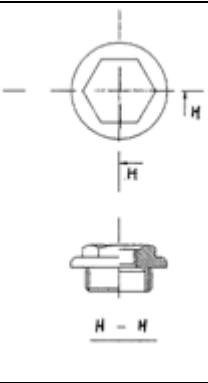
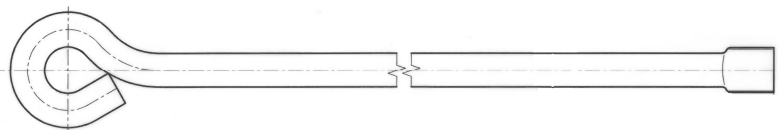
# 1. Utilization of special brackets with holders and spacers – WEMEFA set no. 3

They are used similarly to pipe brackets for fixation of heating bodies to solid walls. Their advantage consists especially in significantly simpler and quicker installation (when drilling holes for brackets it is not necessary to maintain accurate spacing and width of sections in sets). This allows a very simple installation of all types and sizes of heating bodies manufactured.

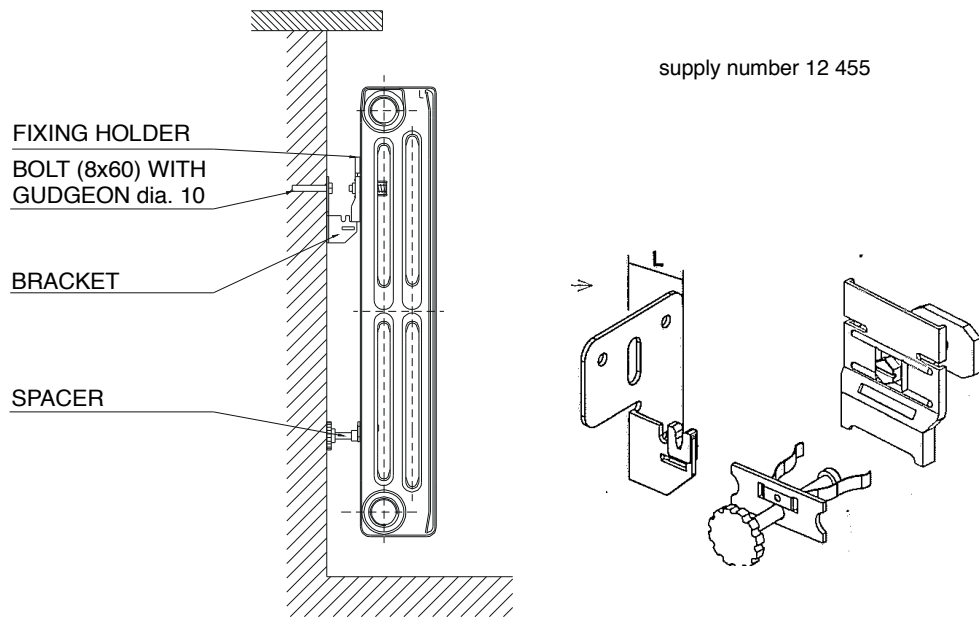
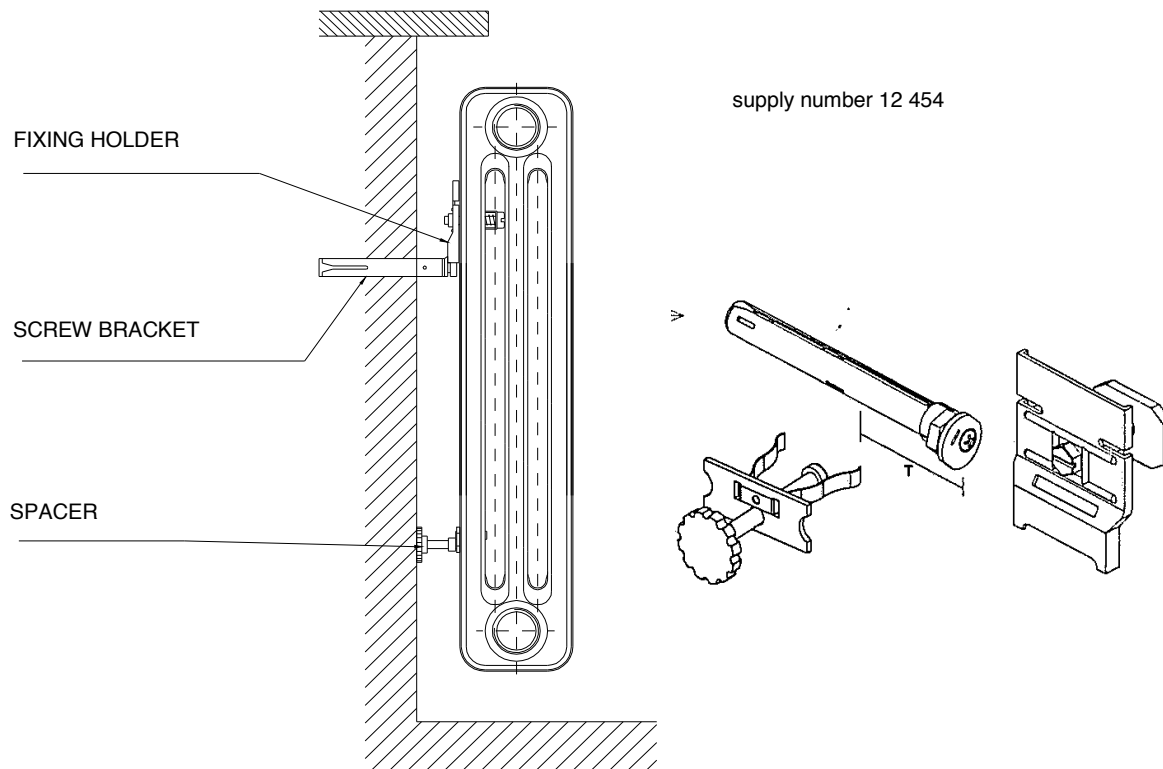

Fig. 2 Fixation of heating bodies using brackets with fixing holders

Tab. № 1 Number of brackets with fixing holders depending on dimension of sections

Dimensions of sections (mm)		Number of sections													
		3	4	6	8	10	12	14	16	18	20	22	24	26	28
Kalor	350/110			2					2		2	2	2	3	3
Kalor	350/160			2					2		2	2	2	3	3
Kalor	500/70			2					2		2	2	2	3	3
Kalor	500/110														
Termo	500/95			2					2		2	2	3	3	3
Kalor 3	350/160														
Kalor 3	500/110			2					2		2	3	3	3	3
Termo	623/95														
Kalor	500/160														
Kalor	600/110														
Kalor	600/160			2					2		3	3	3	3	3
Termo	500/130														
Kalor	500/220														
Kalor 3	500/160														
Termo	623/130			2					2		3	3	3	3	3
Termo	813/95														
Termo	813/130			2					3		3	3	3	4	4
Kalor	900/160			2					3		3	4	4	4	5

**2. Screw brackets with fixing holders and spacers are designed for fixation of heating bodies into hollow walls – WEMEFA set no. 4**



**Fig. 3** Fixation of heating bodies into hollow walls using screw brackets

**Tab. №. 2** Number of screw brackets with fixing holders depending on dimension of sections

Dimensions of sections (mm)	Number of sections														
	3	4	6	8	10	12	14	16	18	20	22	24	26	28	30
Kalor 350/110			2			2			3			3	3	3	3
Kalor 350/160			2			2			3			3	3	3	3
Kalor 500/70			2			2			3			3	3	3	3
Kalor 500/110															
Termo 500/95			2			3			3			3	3	4	4
Kalor 3 350/160															
Kalor 3 500/110			2			3			3			3	4	4	4
Termo 623/95															
Kalor 500/160															
Kalor 600/110		2		3		3		3		4		4	4	4	5
Kalor 600/160															
Termo 500/130															
Kalor 500/220															
Kalor 3 500/160															
Termo 623/130		2		3		3		4		4		4	4	5	5
Termo 813/95															
Termo 813/130		2		3		3		4		4		4	5	5	5
Kalor 900/160		2		3		4		4		5		6	6	6	6

### 3. Fixation of heating bodies to a stand – WEMEFA set no. 7

Indicated method is suitable for manufactured models Kalor, Kalor 3 and Termo. We recommend to use it in rooms with plasterboard partition walls or facing and in all places where it is impossible to apply fixation according to point 1 – 3. Foot of the stand can be fixed into the floor by screwing down or embedding in concrete, e.g. for sizes 900/160, and so on. It is necessary to specify the size of a heating body when placing your order.

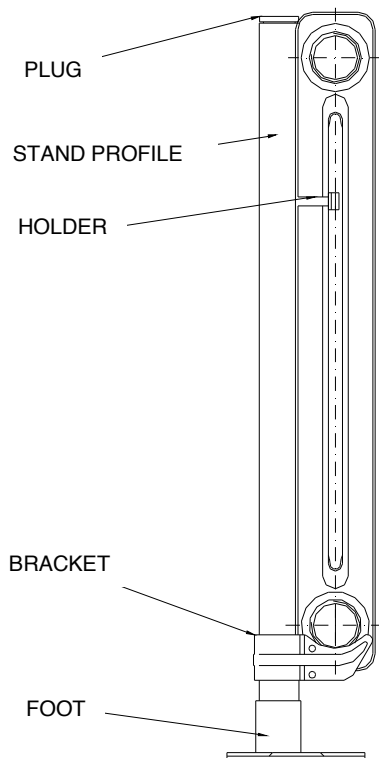

stand's supply number:  
 for heating bodies 350 mm - 15 131  
 for heating bodies 500 mm - 15 132  
 for heating bodies 900 mm - 15 133

supply number 12 294

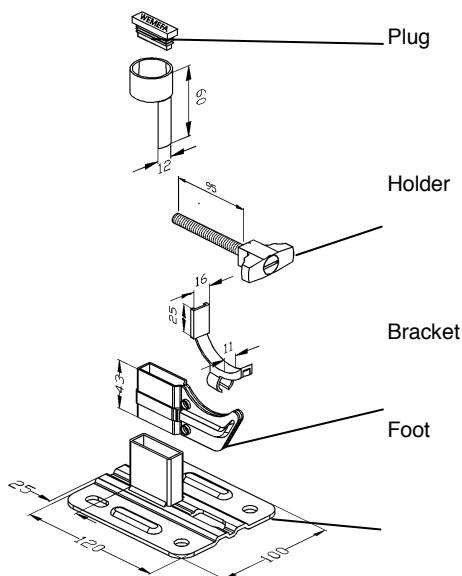

Fig. 4 Fixation of heating bodies using stand

Tab. №. 3 Number of stands depending on dimensions of sections

Dimensions of sections (mm)	Number of sections														
	3	4	6	8	10	12	14	16	18	20	22	24	26	28	30
Kalor 350/110		2				2		3				3	3	3	3
Kalor 350/160		2				2		3				3	3	3	3
Kalor 500/70		2				2		3				3	3	3	3
Kalor 500/110		2				3		3				3	3	4	4
Termo 500/95		2				3		3				3	4	4	4
Kalor 3 350/160		2				3		3				3	4	4	4
Kalor 3 500/110		2				3		3				3	4	4	4
Kalor 500/160		2				3		3				4	4	4	5
Kalor 600/110		2				3		3				4	4	4	5
Kalor 600/160		2				3		3				4	4	4	5
Termo 500/130		2				3		4				4	4	5	5
Kalor 500/220		2				3		4				4	4	5	5
Kalor 3 500/160		2				3		4				4	4	5	5
Kalor 900/160		2				3		4				5	6	6	6

## 4. Using classic radiator pipe brackets and holders

These can be used for fixation of bodies on solid walls. This method is suitable for types **KALOR**, **KALOR 3**, **TERMO**, **lover bracket STYL**.

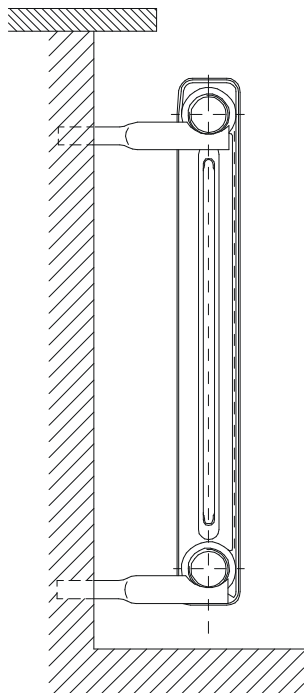

**Fig. 5** Fixation of heating sections using pipe brackets and holders

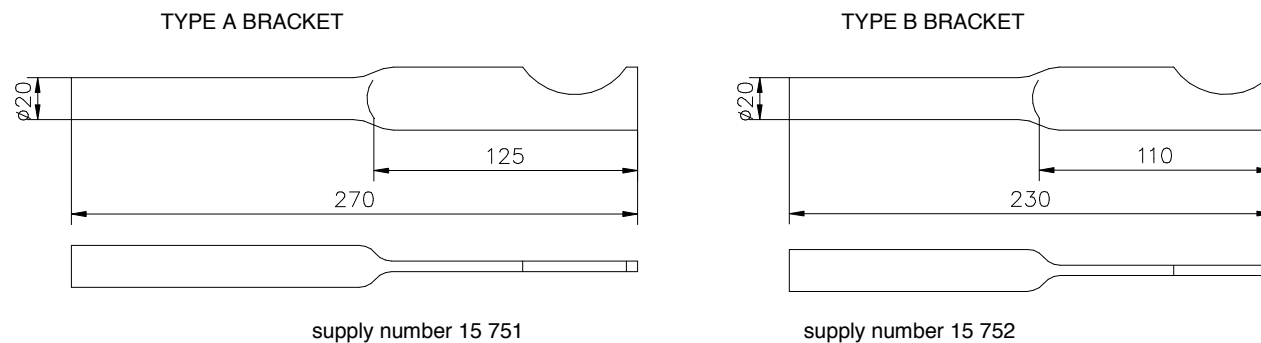

**Fig. 6** Radiator pipe brackets and holder

Selection of a bracket is made based on depth of heating bodies, see Table 4. Number of brackets depending on dimensions and number of sections is indicated in Table 5.

**Tab. №. 4** Recommended types of pipe brackets according to type of heating bodies

Bracket type	Heating body size (spacing / depth)
A	Kalor 350/110, Kalor 350/160, Kalor 500/110, Kalor 500/160, Kalor 500/220, Kalor 600/110, Kalor 600/160, Kalor 900/160
	Kalor 3 350/160, Kalor 3 500/110, Kalor 3 500/160,
	Termo 350/95, Termo 500/95, Termo 500/130, Termo 623/95, Termo 623/130, Termo 813/95, Termo 813/130
	Styl 500/130
B	Kalor 500/70,

Tab. № 5 Number of pipe brackets depending on dimensions of sections

Dimensions of sections (mm)		Number of sections															
		3	4	6	8	10	12	14	16	18	20	22	24	26	28	29	30
Kalor	350/110	2+1		2+2		2+2		3+3		3+3		3+3		4+4		4+4	
Kalor	350/160	2+1		2+2		2+2		3+3		3+3		3+3		4+4		4+4	
Kalor	500/70	2+1		2+2		2+2		3+3		3+3		3+3		4+4		4+4	
Kalor	500/110	2+1		2+2		2+2		3+3		3+3		3+3		4+4		4+4	
Termo	500/95	2+1		2+2		2+2		3+3		3+3		3+3		4+4		4+4	
Kalor 3	350/160	2+1		2+2		2+2		3+3		3+3		3+3		4+4		4+4	
Kalor 3	500/110	2+1		2+2		2+2		3+3		3+3		3+3		4+4		4+4	
Termo	623/95	2+1		2+2		2+2		3+3		3+3		3+3		4+4		4+4	
Kalor	500/160	2+1		2+2		2+2		3+3		3+3		4+4		4+4		4+4	
Kalor	600/110	2+1		2+2		2+2		3+3		3+3		4+4		4+4		4+4	
Kalor	600/160	2+1		2+2		2+2		3+3		3+3		4+4		4+4		4+4	
Termo	500/130	2+1		2+2		2+2		3+3		3+3		4+4		4+4		4+4	
Kalor 3	500/160	2+1		2+2		2+2		3+3		3+3		4+4		4+4		4+4	
Termo	623/130	2+1		2+2		2+2		3+3		3+3		4+4		4+4		4+4	
Termo	813/95	2+1		2+2		2+2		3+3		3+3		4+4		4+4		4+4	
Termo	813/130	2+1		2+2		2+2		3+3		3+3		4+4		4+4		4+4	
Kalor	500/220	2+1		2+2		2+2		3+3		3+3		4+4		4+4		4+4	
Kalor	900/160	2+1		2+2		3+3		4+4		5+5		5+5		5+5		6+6	
Styl	500/130	2+1		2+2		2+2		3+3		3+3		4+4		4+4		4+4	

### 5. Clamping by means of the screw consoles

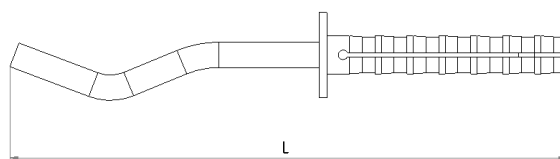
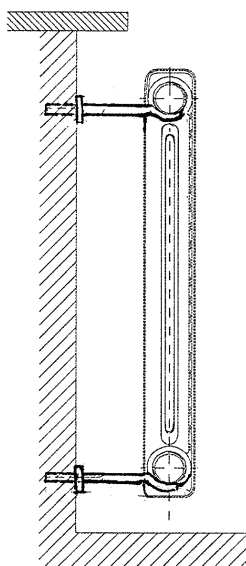

supply number  
 12 559 12 x 200 mm  
 12 560 12 x 230 mm  
 12 561 12 x 260 mm

Fig. 7 Clamping by means of the screw consoles

Fig. 8 Screw console

Tab. № 6 Number of brackets depending on dimensions of sections

Dimensions of brackets (mm)		Dimensions of sections (mm)		Number of sections														
				3	4	6	8	10	12	14	16	18	20	22	24	26	28	29
200	Kalor	350/110	2+1		2+2		2+2		3+3		3+3		3+3		4+4		4+4	
230	Kalor	350/160	2+1		2+2		2+2		3+3		3+3		3+3		4+4		4+4	
200	Kalor	500/70	2+1		2+2		2+2		3+3		3+3		3+3		4+4		4+4	
200	Kalor	500/110	2+1		2+2		2+2		3+3		3+3		3+3		4+4		4+4	
200	Termo	500/95	2+1		2+2		2+2		3+3		3+3		3+3		4+4		4+4	
230	Kalor	350/160	2+1		2+2		2+2		3+3		3+3		3+3		4+4		4+4	
230	Kalor 3	350/160	2+1		2+2		2+2		3+3		3+3		3+3		4+4		4+4	
200	Kalor 3	500/110	2+1		2+2		2+2		3+3		3+3		3+3		4+4		4+4	
200	Termo	623/95	2+1		2+2		2+2		3+3		3+3		3+3		4+4		4+4	
230	Kalor	500/160	2+1		2+2		2+2		3+3		3+3		4+4		4+4		4+4	
200	Kalor	600/110	2+1		2+2		2+2		3+3		3+3		4+4		4+4		4+4	
230	Kalor	600/160	2+1		2+2		2+2		3+3		3+3		4+4		4+4		4+4	
230	Termo	500/130	2+1		2+2		2+2		3+3		3+3		4+4		4+4		4+4	
230	Kalor 3	500/160	2+1		2+2		2+2		3+3		3+3		4+4		4+4		4+4	
230	Termo	623/130	2+1		2+2		2+2		3+3		3+3		4+4		4+4		4+4	
200	Termo	813/95	2+1		2+2		2+2		3+3		3+3		4+4		4+4		4+4	
230	Termo	813/130	2+1		2+2		2+2		3+3		3+3		4+4		4+4		4+4	
260	Kalor	500/220	2+1		2+2		2+2		3+3		3+3		4+4		4+4		4+4	
230	Kalor	900/160	2+1		2+2		3+3		4+4		5+5		5+5		5+5		6+6	
230	Styl	500/130	2+1		2+2		2+2		3+3		3+3		4+4		4+4		4+4	



## 6. Installation using the HG-TEC brackets



The figure shows a set of the HG-TEC brackets. Each package always contains 2 sets of the brackets. The tables indicate the required **number of sets** (not the packages) for the specific number of the heating bodies sections.

Tab. №. 7 Number of brackets depending on dimensions of sections

	Number of sections															
	3	4	6	8	10	12	14	16	18	20	22	24	26	28	29	30
Kalor 350/110	2						4									
Kalor 350/160	2						4									
Kalor 500/70	2						4									
Kalor 500/110	2						4									
Kalor 500/160	2						4									
Kalor 500/220	2			4						6						
Kalor 600/110	2			4												
Kalor 600/160	2			4												
Kalor 900/160	2	4						6								
Kalor 3 350/160	2						4									
Kalor 3 500/110	2						4									
Kalor 3 500/160	2			4												
Termo 500/95	2						4									
Termo 500/130	2			4												
Termo 623/95	2			4												
Termo 623/130	2			4												
Termo 813/95	2			4												
Termo 813/130	2	4						6								
Styl 500/130	2						4									

## 7. Upper gripping of KALOR, KALOR 3, TERMO and STYL radiator

Due to the access to this mounting it is **necessary** to position the upper clamping between the first and second column of the radiator.

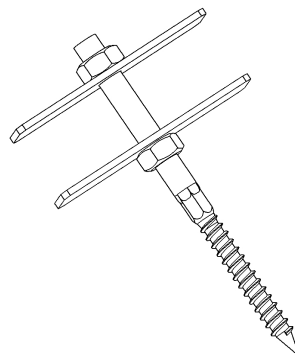
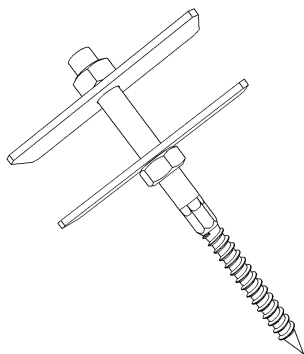

supply number 14 331

supply number 11486

**Fig. 9** Upper gripping of Kalor, Kalor 3, Termo and Styl radiator – lenght 140 mm

**Fig. 10** Upper gripping of Termo radiator– lenght 180 mm

**Tab. №. 8** Number of upper gripping depending on dimensions of sections

Dimensions of sections (mm)	Number of sections														
	3	4	6	8	10	12	14	16	18	20	22	24	26	28	30
Kalor 350/110			2				2			2		2	2	2	2
Kalor 350/160			2				2			2		2	2	2	2
Kalor 500/70			2				2			2		2	2	2	2
Kalor 500/110			2				2			2		2	2	2	2
Kalor 500/160			2				2			2		2	2	2	2
Kalor 500/220			2				2			2		2	2	2	2
Kalor 600/110			2				2			2		2	2	2	2
Kalor 600/160			2				2			2		2	2	2	2
Kalor 900/160			2				2			2		2	2	2	2
Kalor 3 350/160			2				2			2		2	2	2	2
Kalor 3 500/110			2				2			2		2	2	2	2
Kalor 3 500/160			2				2			2		2	2	2	2
Termo 500/130			2				2			2		2	2	2	2
Termo 623/130			2				2			2		2	2	2	2
Termo 813/130			2				2			2		2	2	2	2
Styl 500/130			2				2			2		2	2	2	2

**Tab. №. 9** Number of upper gripping depending on dimensions of sections

Dimensions of sections (mm)	Number of sections														
	3	4	6	8	10	12	14	16	18	20	22	24	26	28	30
Termo 500/95			2				2			2		2	2	2	2
Termo 623/95			2				2			2		2	2	2	2
Termo 813/95			2				2			2		2	2	2	2

## 8. Support under KALOR and KALOR 3 heating body

This fixation method is used for **KALOR** and **KALOR 3** heating bodies in combination with holders.

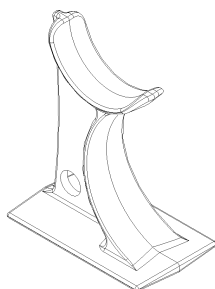

**Dimensions of support:**  
 Height 123 mm  
 Width 60 mm  
 Depth 100 mm

supply number 9213

**Fig. 11** Support under heating bodies KALOR and KALOR 3

**Tab. № 10** Number of supports depending on dimensions of sections KALOR

Dimensions of sections (mm)	Number of sections													
	3	4	6	8	10	12	14	16	18	20	22	24	26	28
Kalor 350/110			2				3			4	4	4	5	5
Kalor 350/160			2				3			4	4	4	5	5
Kalor 500/70			2				3			4	4	4	5	5
Kalor 500/110			2				3			4	4	4	5	5
Kalor 500/160			2				3			4	4	4	5	5
Kalor 500/220			2				3			4	4	4	5	5
Kalor 600/110			2				3			4	4	4	5	5
Kalor 600/160			2				3			4	4	4	5	5
Kalor 900/160			2				3			4	4	4	5	5

**Tab. № 11** Number of supports depending on dimensions of sections KALOR 3

Dimensions of sections (mm)	Number of sections													
	3	4	6	8	10	12	14	16	18	20	22	24	26	28
Kalor 3 350/160			2				3			4	4	4	5	5
Kalor 3 500/110			2				3			4	4	4	5	5
Kalor 3 500/160			2				3			4	4	4	5	5

## 9. Support under STYL and TERMO heating body

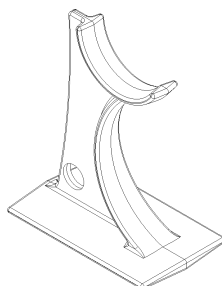

**Dimensions of support:**  
 Height 118,5 mm  
 Width 60 mm  
 Depth 100 mm

supply number 11 485

**Fig. 12** Support under heating bodies STYL and TERMO

**Tab. № 12** Number of supports depending on dimensions of sections TERMO

Dimensions of sections (mm)	Number of sections													
	3	4	6	8	10	12	14	16	18	20	22	24	26	28
Termo 500/95			2				3			4	4	4	5	5
Termo 500/130			2				3			4	4	4	5	5
Termo 623/95			2				3			4	4	4	5	5
Termo 623/130			2				3			4	4	4	5	5
Termo 813/95			2				3			4	4	4	5	5
Termo 813/130			2				3			4	4	4	5	5

**Tab. № 13** Number of supports depending on dimensions of sections STYL

Dimensions of sections (mm)	Number of sections													
	3	4	6	8	10	12	14	16	18	20	22	24	26	28
Styl 500/130			2				3			4	4	4	5	5